

28-29-52 Gamaguchi Purse



Suggested yarn:

- Pierrot Yarns Soft Merino Bulky [100% merino wool; 44 yds/40m per 1.41 oz./40g skein]; color #6 light gray, 1 skein [20g]
- Pierrot Yarns Junmo Namibuto2 [100% superwash wool; 79 yds/72m per 1.41 oz./40g skein]; color #1 off-white, 1 skein [small amount]

Tools/Notions:

- 6.3mm (approx. US 10½) knitting needles or size necessary to achieve gauge
- 5.0mm (US H) crochet hook or size necessary to achieve gauge
- darning needle & thread or yarn to use for seaming
- metal purse frame

Finished measurements:

- Please see schematics.

Gauge (10cm/4" square):

- stockinette stitch: 13 sts and 17 rows

Gauge may vary according to individual knitting style. Change needle size if necessary to achieve gauge. Alternatively, rework pattern with your own gauge measurements.

Knitting Tips

Cast on with long-tail cast-on method and work in stockinette stitch. Make 2 identical pieces according to schematic. With right sides facing, seam bottom with slip stitch seam, then turn right-side out. Work 1 rounds of single crochet (US) around mouth of bag. Place frame along single crochet edge and fasten in place. Make a strap by working a crochet chain. Attach tassels to each tip of the chain and fasten cord to sides of bag.

Abbreviations:

BO = bind off
inc = increase
RE = row(s) even
sc = single crochet (US)
#-#-# = rows-stitches-times

Gamaguchi Purse

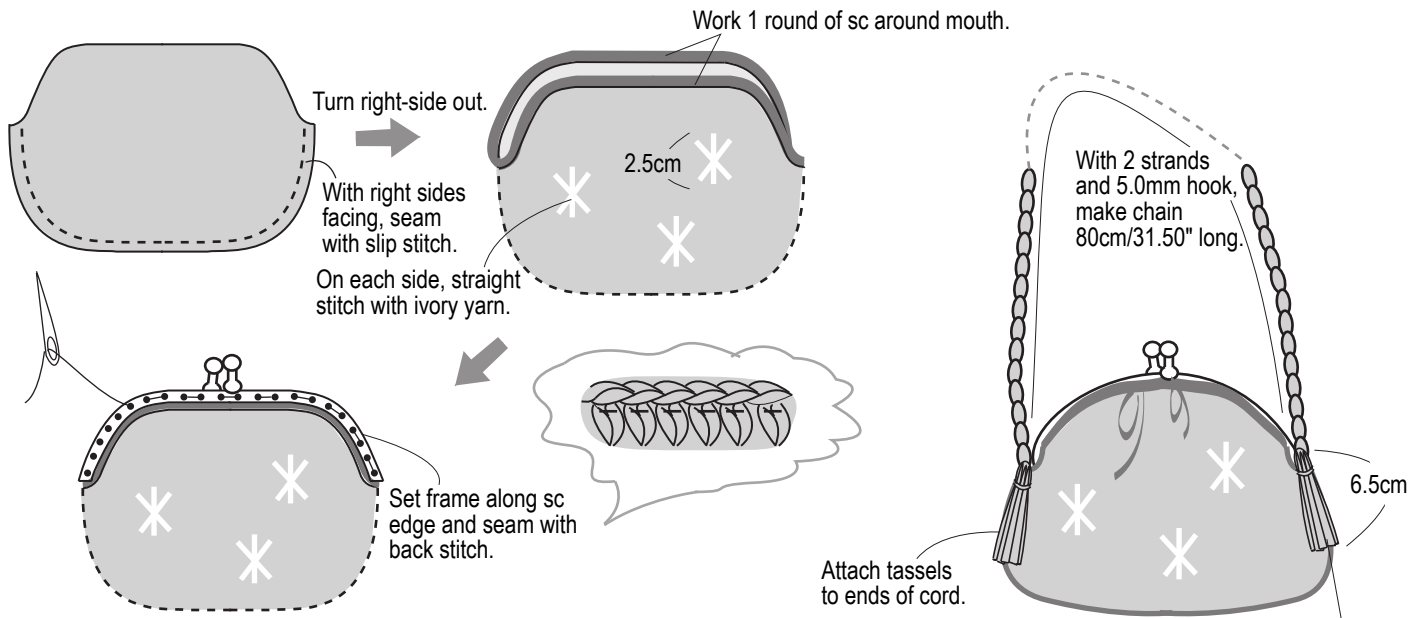

Tassel: wrap 6 times around 16cm/6.30" cardboard; fold in two.

Pattern schematic

